

PEARL EC

AIRIUSFANS.COM | 888-247-7327

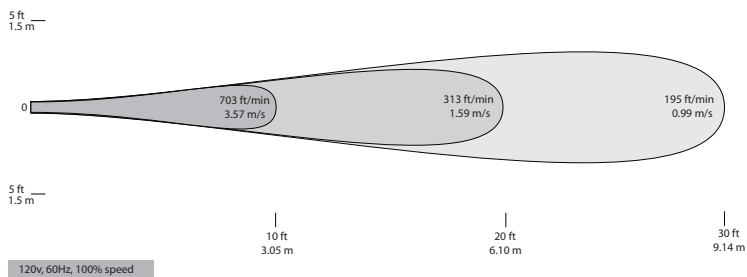

Housing: ABS, UL 94 5VA flame resistance. For increased chemical resistance to oils and alkalis.

Hardware: Stainless steel for increased corrosion resistance.

Motor: 230mm, electrically commutated, thermally-protected axial motor. Operating temperature: -22°F (-30°C) to 122°F (50°C). No lubrication required, bearings are sealed.

Power Cord: 6 foot cord and plug provided for 100-130V fans, no plug for 200-250V.

Control Input: 0-10VDC.

Certification: Conforms to UL-507, CAN/CSA-C22.2 No. 1113. ETL listed in USA and Canada.

Warranty: 3 years parts and workmanship.

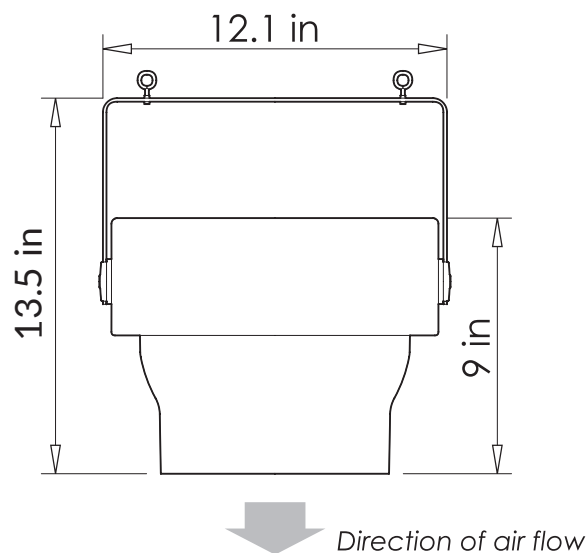

Technical Specifications



Model	Input Power, 1 Ø	Amps	Watts	RPM	dB(A) ¹	Weight	Colors
P-E1-STD-100-130-(X)	100-130VAC, 60Hz	0.46	31	1640	44, 42, 40	6 lbs.	X = Off white (W) or black (B)
P-E1-STD-200-250-(X)	200-250VAC, 60Hz	0.26	30	1700	44, 42, 40	6 lbs.	X = Off white (W) or black (B)

(1) Calculated sound pressure at 5, 10 and 15 foot distances based on non-reflective area. 62 dB(A) Sound Power Level, designed to meet ISO 3744 - engineering grade precision for determining sound power. Data independently verified by third party. Tests performed in-unit.

Controls & Factory Installed Options

Item	Description
Pearlink-F	Pearlink Fan Sensor- One Per Fan. Wi-Fi iOS/Android App based controller. Factory installed option.
Pearlink-T	Pearlink wired (120v) Floor Thermostat- One Per Room
POT-1	Wall-mounted speed control. Low voltage control wiring daisy-chained between fans to be controlled as a group.
AiriusBAC24	BACnet MS/TP card for integration with an existing BACnet system. Individually control speed, on/off and monitor fan status.
GUARD25	Intake grille: Phosphated steel coated in black plastic. Factory installed option.
DeltaT-EC-Pack	Includes wall mounted control interface, two temperature sensors and 24VDC power supply. 0-10VDC output.

Model:	X = Off white (W) or black (B)	Qty:
Controls/Options:		Qty: